



X-VERTER 3024WM

High performance **INVERTOR**
for provide extended backup



**X-
V-
E-
R-
T-
E-
R**

The series X-Verter is an advanced Line-Interactive Uninterruptible Power System which produces pure sine wave power to your equipment; unlike the traditional off-line UPS, the series provides very short transference when blackouts happen, and zero transference from AC mode to battery mode and vice versa.

The voltage regulation of the series is similar to an On-line UPS; however, the series provide efficiency over 98% under normal power condition. Two charge modes, quick charge and trickle charge, are provided to maintain the batteries in the best condition.

FEATURES

- Pure sine wave output.
- Microprocessor based design.
- True Line-Interactive structure.
- Smartest charging, fast & stable.
- Zero Transference.
- Real time auto-detection for battery condition.
- Remote LCD display.
- RS-232 interface for communication, compatible with all major O.S., including Windows, Linux, SCO UNIX, & DOS.
- Protection for overload, short circuit, & over heat.



X-VERTER 3024WM

Model	
Capacity	3000VA / 2400W
Input	
Voltage	Selectable 100/110/115/120V 1 ϕ or 220/230/240V 1 ϕ
Voltage range	-21% ~ +22% for 5% AVR or -34% ~ + 36% for 8% AVR
Frequency	50Hz/60Hz Auto detect
Current (110/220V)	34A / 17A
Output	
Voltage	100/110/115/120V 1 ϕ or 220/230/240V 1 ϕ \pm 3% for Back-up Mode
AVR	< \pm 5 for AVR or \pm 8% for AVR (optional)
Frequency	50Hz or 60Hz \pm 0.1Hz
Wave Form	Pure Sine Wave
Current (110/220V)	28A / 14A
Transfer time	3.5m typical
Tiempo de transferencia	Lead-Acid, maintenance free battery
Battery	
Voltage	24V
Level Ind.	LCD
Charging current	25A Max.
LED/Alarm indication	
Normal city power	No Beep
Back up Mode	2 Beeps/4sec. (Transfer to backup mode)
Abnormal Freq. of city power (Frequency >65Hz or < 47Hz)	2 Beeps/4sec. (Transfer to backup mode)
Abnormal voltage of city power (Out of AVR range)	2 Beeps/4sec. (Transfer to backup mode)
Abnormal voltage of city power Too high - Too Low	No Beep. (AVR in operation)
Low battery alarm	4 Beep/sec.
Battery fail alarm	8 Beep/sec.
Over load alarm	Continuously
Thermal alarm	3 beeps/2sec. Silence/2sec.
LCD indicators/Load level indication	
	Load level - DC star / alarm reset - Green power funtion - RS-232 interface
Environmet tem. / humidity	0 - 37 $^{\circ}$ C 30-95% Non-condensing
Dimensions (LxHxW) cm	51 x 18 x 20
Shipping Dim. (LxHxW) cm	61 x 30 x 33
Weight (N.W. / G.W.) Kgs	31 / 33

Specifications are subject to change without notice

Features:

1. Input circuit breaker
2. Input terminal of city power
3. Output circuit breaker for outlets
4. Output terminal & Outlets (IEC or NEMA)
5. RS-232 Interface port
6. DIP Switch
7. Battery connector
8. Connector for solar panel (Optional)
9. Internal SNMP Slot or USB (Optional)
10. Auto-bypass On/Off Switch
(Turn on switch to enable auto-bypass function)
11. Bypass LED Indicator

REAR PANEL

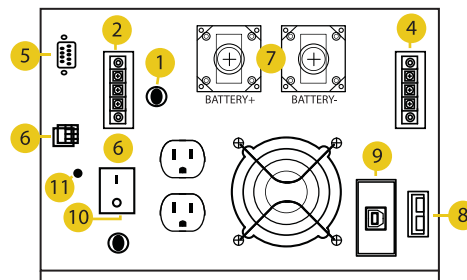

CDP COLOMBIA
colombia@cdpups.com



CDP GUATEMALA
guatemala@cdpups.com



CDP CHINA
china@cdpups.com



CDP COSTA RICA
costarica@cdpups.com



CDP VENEZUELA
venezuela@cdpups.com



CDP HONG KONG
hongkong@cdpups.com



CDP MÉXICO
mexico@cdpups.com



CDP PERÚ
peru@cdpups.com



CDP USA
usa@cdpups.com

